

CNC LATHE INTRODUCTION

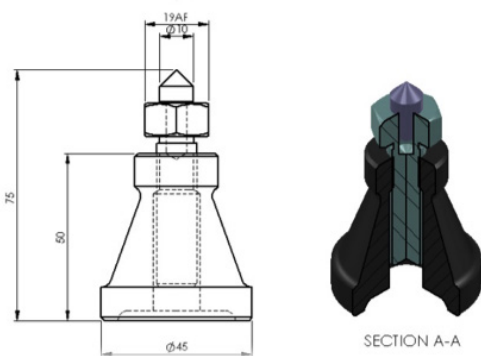

AREAS COVERED

- Safety on and around CNC Lathes
- Start-up, Shut-down & Basic Maintenance of CNC Lathes
- Setting of Tools & Jaws
- Basic Lathe Programming (Fanuc)
- Sample of Repetitive Cycles
 - a. Rough turning
 - b. Finish turning
 - c. Threading
- Operation of the Lathe with a Small part project (screw jack)

LOCATION

Midland Campus (Lloyd Street Midland)

Time: Five sessions 5.30 to 9.00pm Wednesday

Dates: 08/02/17 to 08/03/17
03/05/17 to 31/05/17
19/07/17 to 16/08/17
23/08/17 to 20/09/17
04/10/17 to 01/11/17
08/11/17 to 06/12/17

COURSE COST

\$450 includes gst

Minimum numbers 10, maximum numbers 12

CONTACT

Email: coordinator.balmid@nmtafe.wa.edu.au
Phone: 9374 6328